



Welcome to The Park View Lounge at 9W57, a premier meetings and events facility located in the heart of Midtown Manhattan on 57th Street, just two blocks from Central Park. This unique multi-purpose venue offers 5-star hospitality services across a variety of meeting rooms and social spaces.

Designed to be light, bright, and high-tech, The Park View Lounge at 9W57 is purpose-built to accommodate a wide range of events. Whether you're planning corporate day meetings, holiday parties, board meetings, trainings, or collaborative work functions, our full-service hospitality team is dedicated to ensuring your event is a success. Experience unparalleled service and a versatile space that adapts to your needs at The Park View Lounge at 9W57.



**BEST-IN-CLASS TECHNOLOGY**



**FLEXIBLE MEETING & EVENT SPACE**



**FIVE STAR HOSPITALITY SERVICE**



**DEDICATED EVENT PLANNING SERVICES**



**GOURMET CULINARY OFFERINGS**



**PANORAMIC VIEWS OF MANHATTAN**



# FLOOR PLAN

## 27th Floor Plan

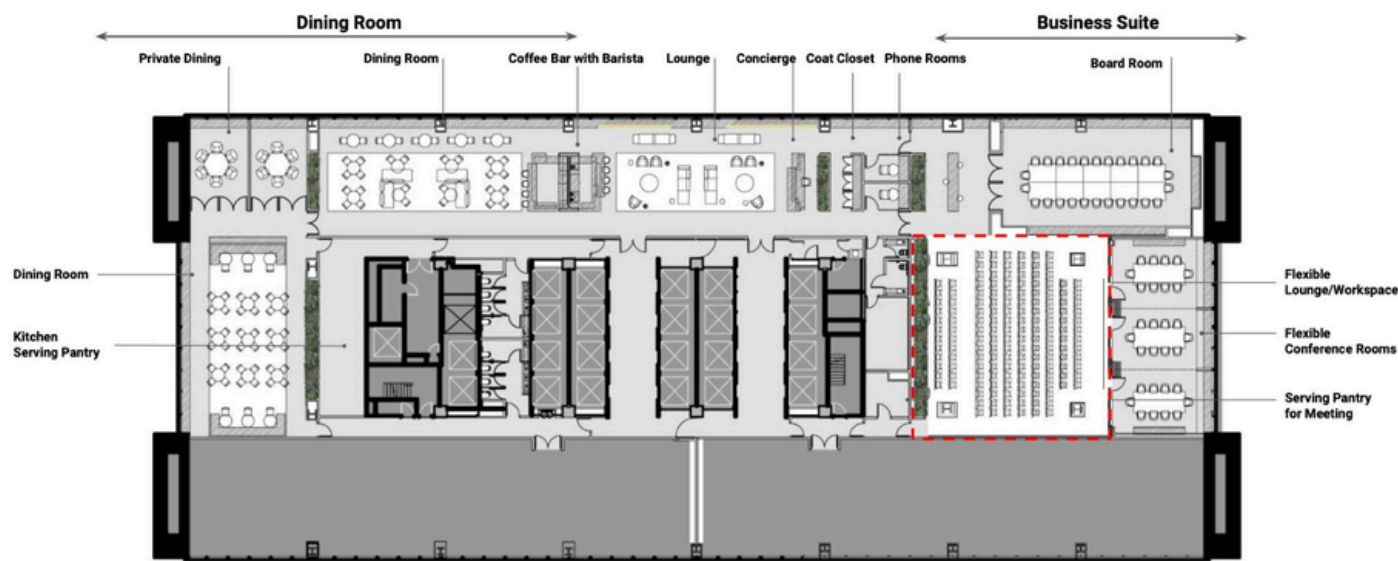

# CAPACITY CHART

	DIMENSIONS/SQUARE FEET	MAX CAPACITY
THE BOARDROOM	42 ft long x 27 ft wide- 1134 sq feet	30
TOWN HALL	27 ft long x 30 ft wide- 810 sq feet	130
TOPAZ, QUARTZ & SAPPHIRE ROOMS	24 ft long x 14 ft wide- 336 sq feet	10 EACH
CAFE & BAR LOUNGE	114 ft long x 27 ft wide- 3078 square feet	200

